

Legende Ziegeltypen

- Redbloc Systemwände**
KfW??
(sämtliche Maße sind Rohbaumaße)
- Außenwand S8-365 mm
 - Innenwand Plan T0,8-115 mm
 - Innenwand Plan T0,8-175 mm
 - Innenwand Plan T0,8-240 mm
 - Innenwand Plan T1,0-240 mm
 - Innenwand Plan T1,2-175 mm
 - Innenwand Plan T1,2-240 mm
 - Innenwand Plan T1,4-115 mm
 - Innenwand Mz-T2,0-115 mm
 - Treppenhautrennwand S-Pz-240 mm
 - Wohnungtrennwand S-Pz-300 mm
 - Aufzugschachtwand C25/30-200 mm
 - Doppelwand 250mm + 120mm Dämmung
 - Doppelwand 250mm + 60mm Dämmung

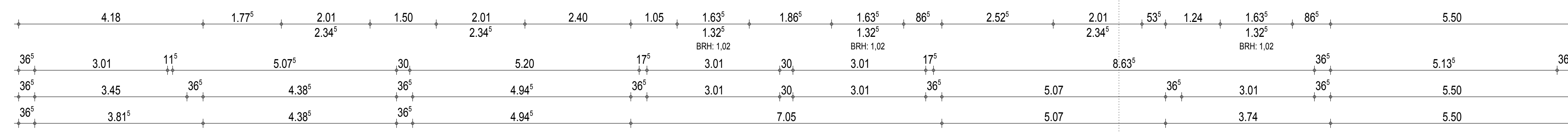
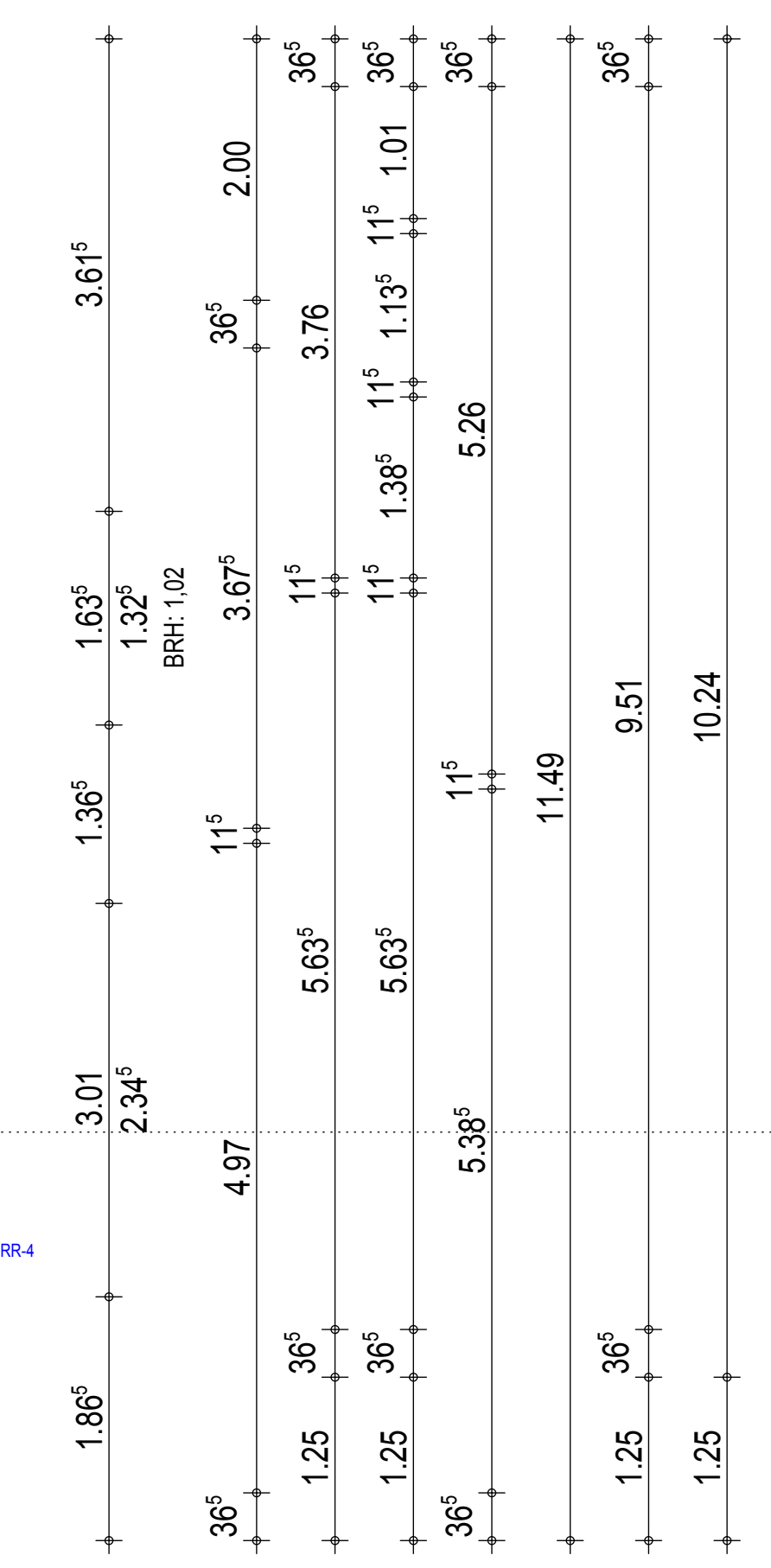
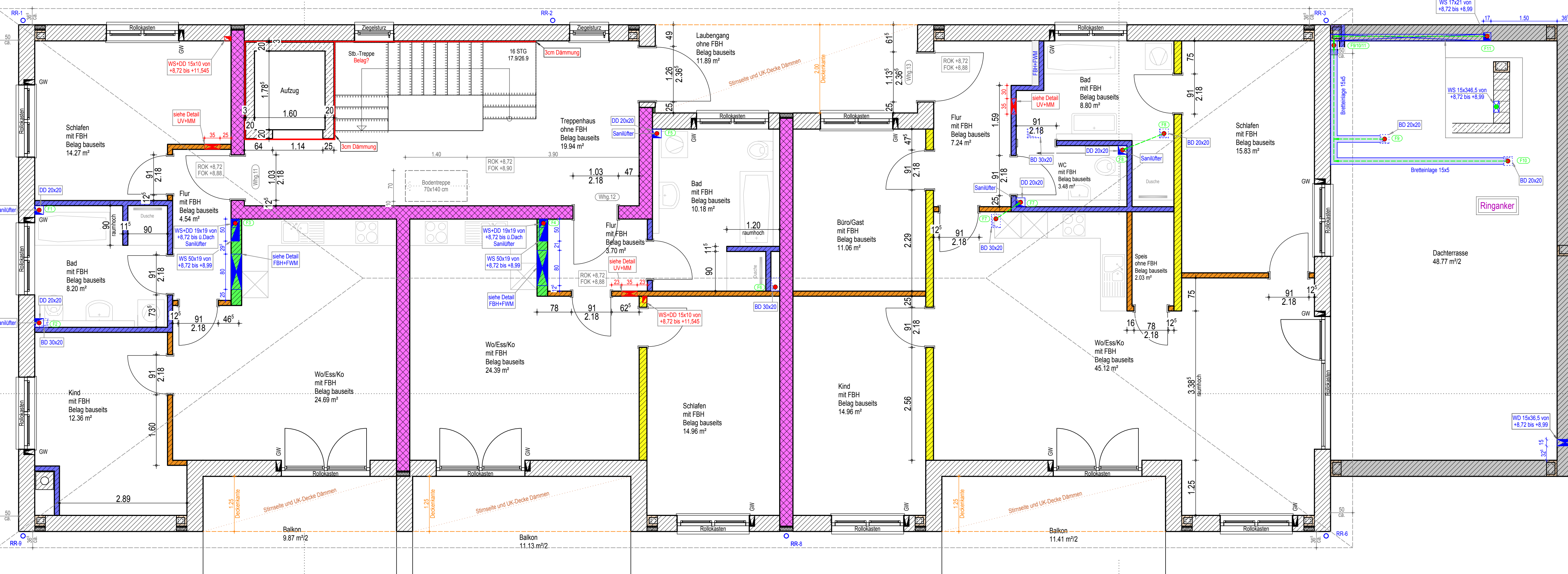
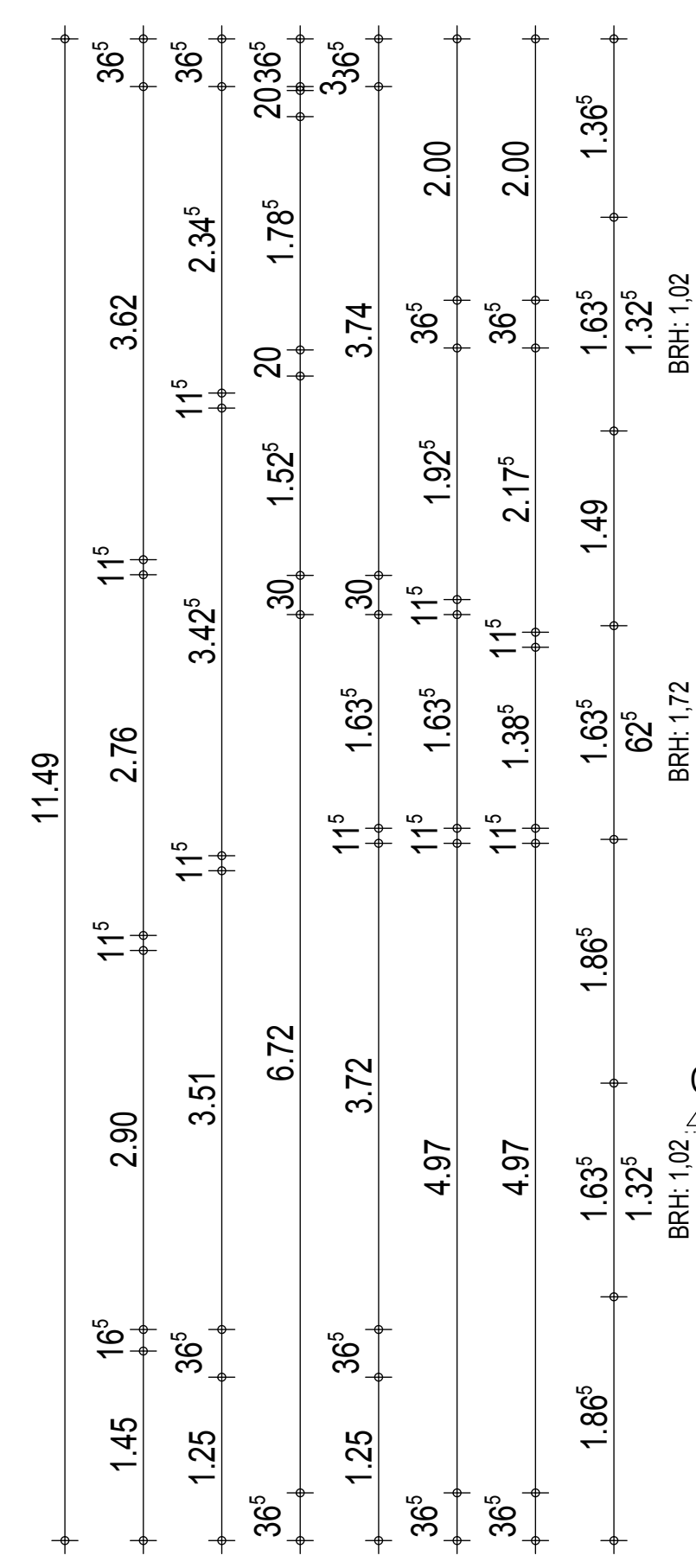

Grundriss 3. Obergeschoss